



*IMPIANTI DI BETONAGGIO - CENTRALES À BÉTON  
BATCHING PLANT - BETONMISCHALANGEN*

**CALCESTRUZZO DI QUALITÀ - BÉTON DE QUALITÉ  
TOP QUALITY CONCRETE - HOCHWERTIG BETON**



***BW MIXER***

*IMPIANTI DI BETONAGGIO - CENTRALES À BÉTON  
BATCHING PLANT - BETONMISCHALANGEN*

# BW MIXER LAY OUT

- ■ Impianti per carico autobetoniera fissi con produzioni da 50 a 200 mc/h.
- ■ Batching plants to feed truck mixer with productions from 50 to 200 mc/h.
- ■ Centrales à béton pour alimentation de camion malaxeur avec productions de 50 à 200 mc/h.

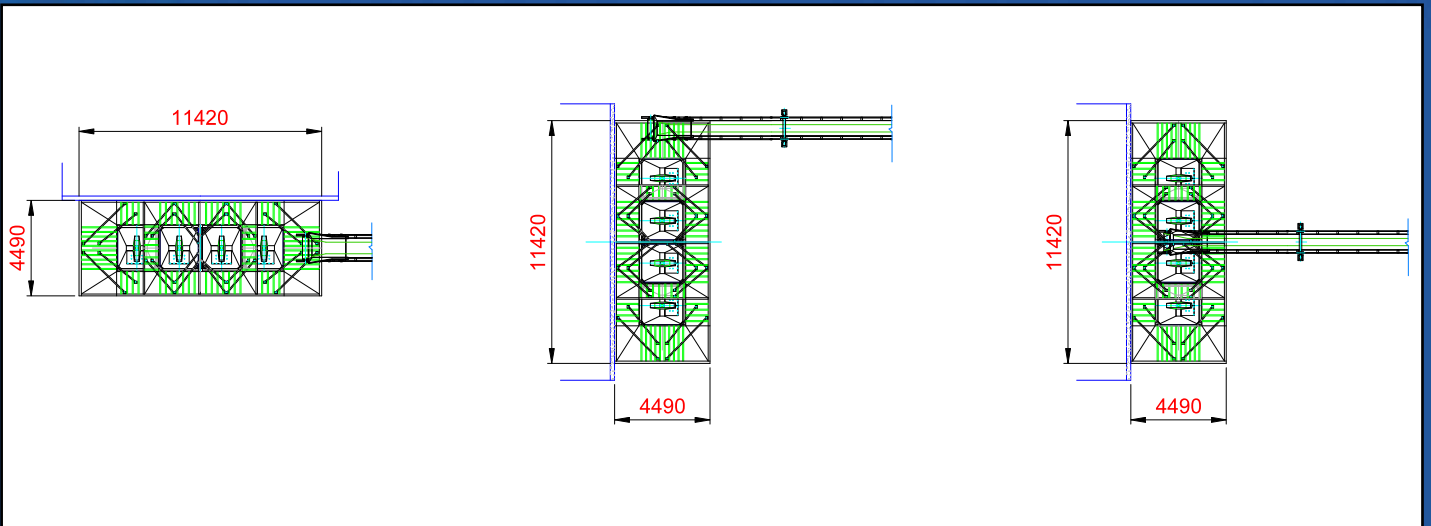
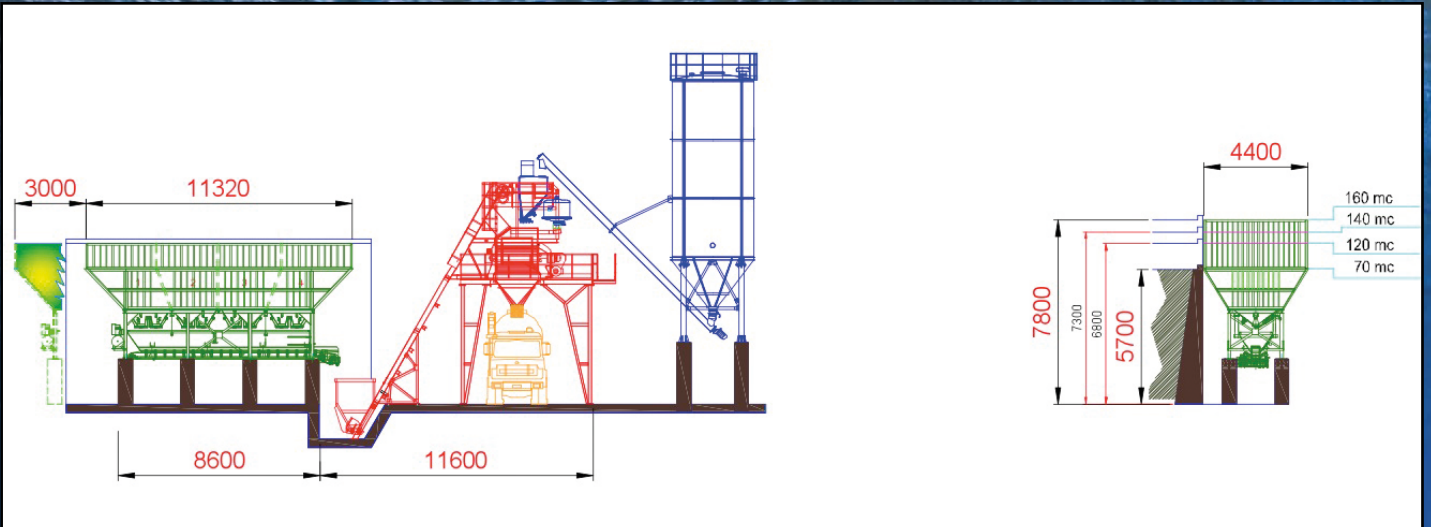
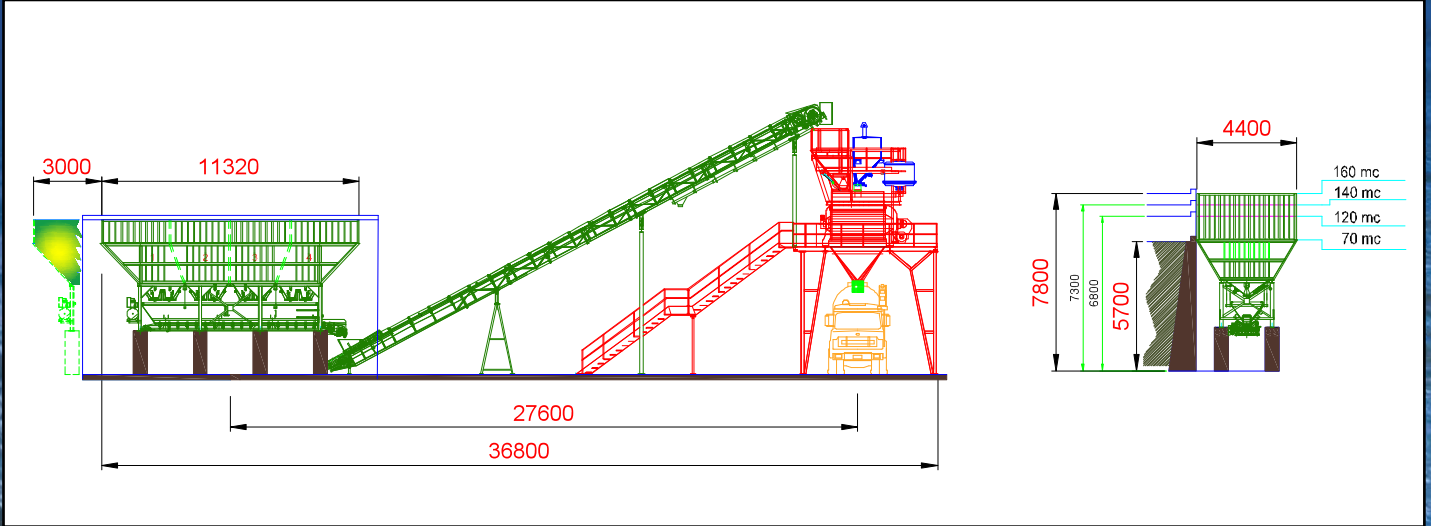



# MIXER - PRODUCTION MC/H

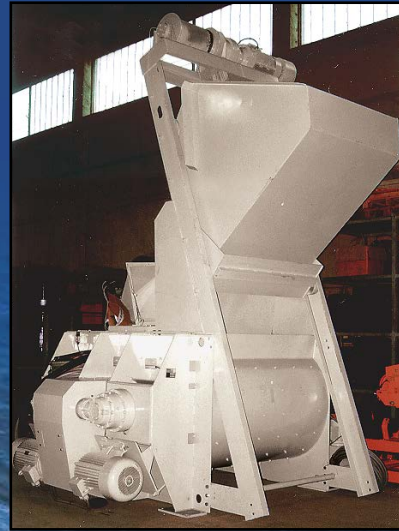

# AGGREGATE

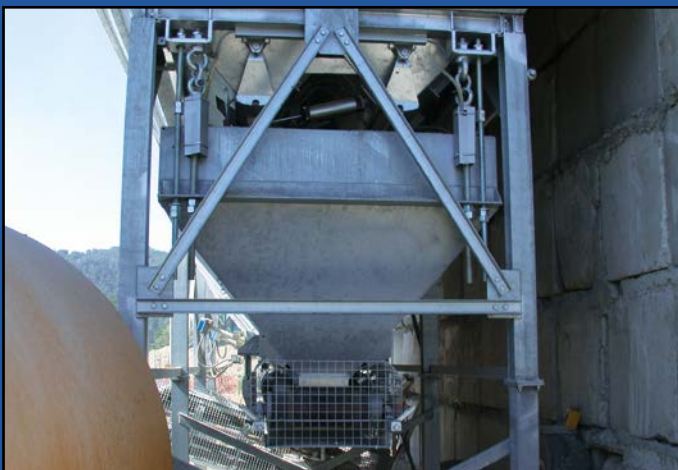
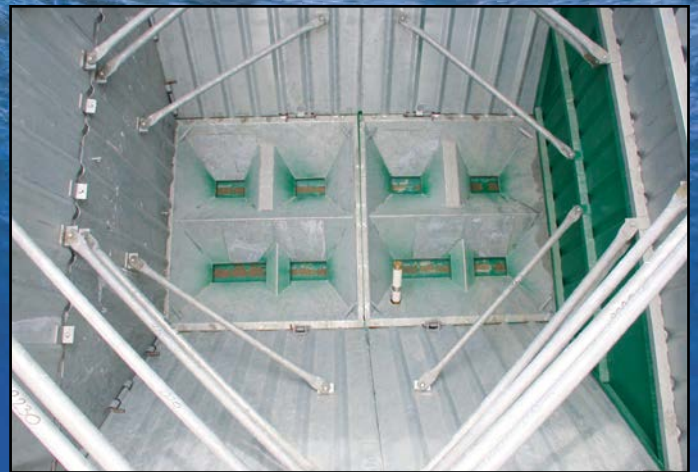











# CONTROL & SOFTWARE

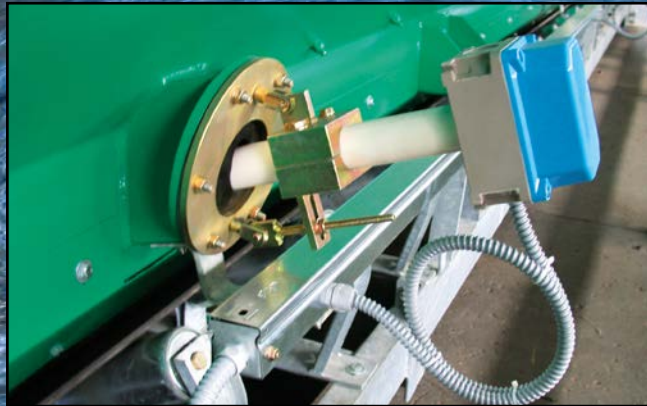
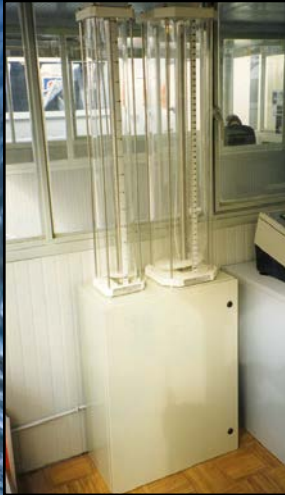
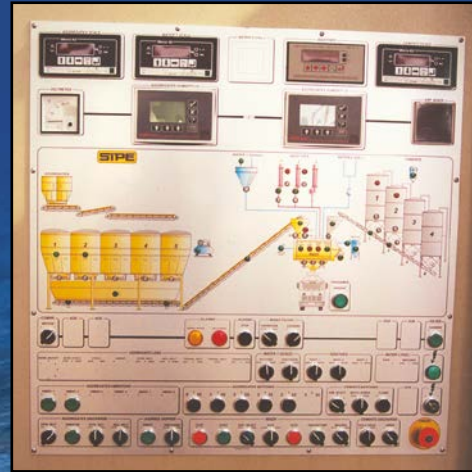

# CEMENT





# OPTIONS







**CST S.r.l. - Via Sigalina a Mattina, 10-10a/b/c - 25018 MONTICHIARI (BS) ITALY  
Tel. +39.030.9962231 - Fax +39.030.9659638 - web: [www.sipeitalia.eu](http://www.sipeitalia.eu) - e-mail: [info@cstplants.com](mailto:info@cstplants.com)**